

ultraframe *Orangery*

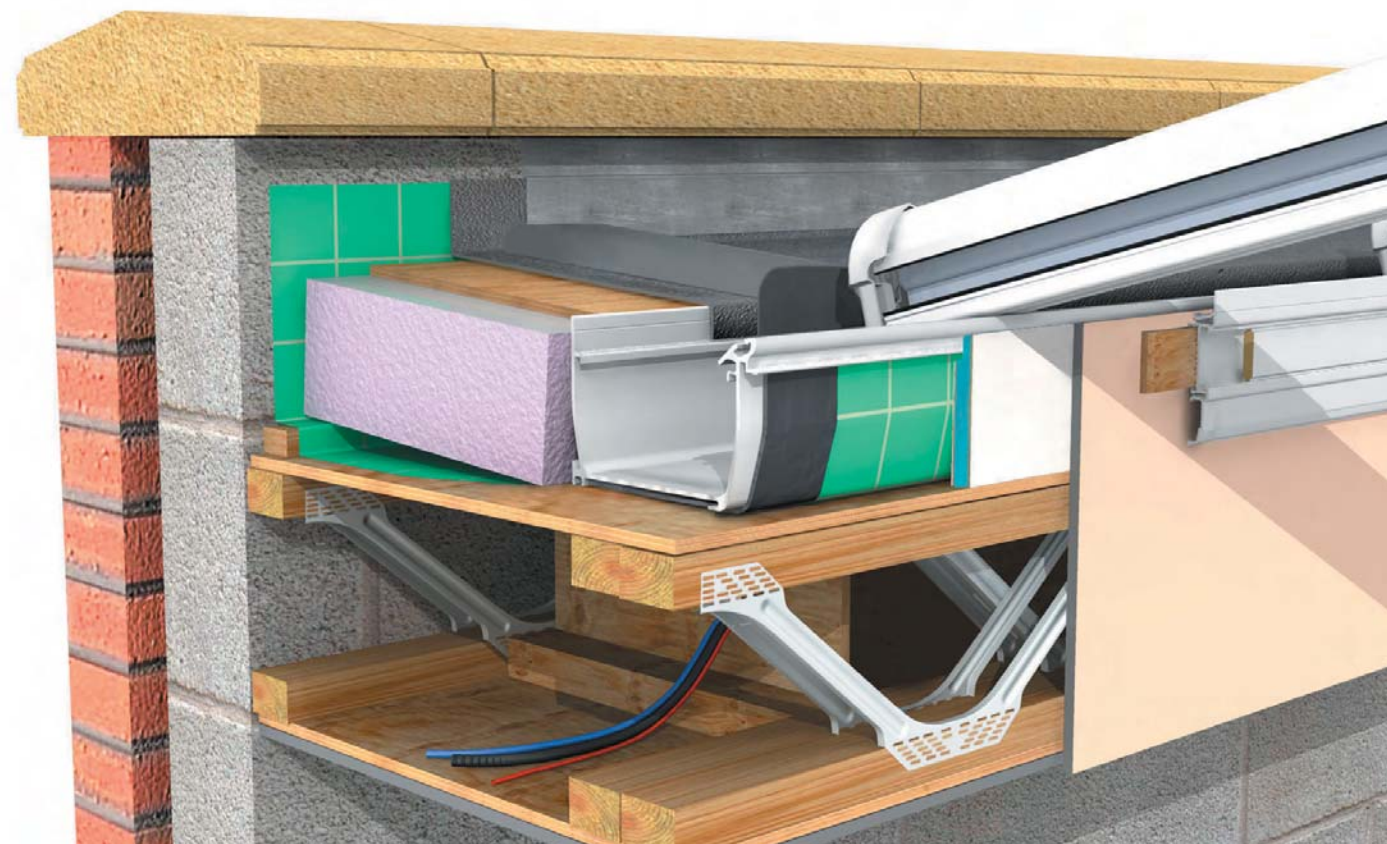

Installation Guide

Version 1.0
Feb 2011

Dear Customer,

Thank you for choosing the Ultraframe Orangery system.

When you commence installation of the roof, please read the main Classic or Classic Plus guide that comes with the roof. It is critical that you follow this guide closely and you will need to co-ordinate masonry trades carefully when installing/completing the Orangery roof.

Any feedback –positive or negative – is welcomed so we can make the Classic roof even better. Please contact tech support on 0843 208 6953 or email techsupport@ultraframe.co.uk

The Orangery System

Drawing is not to scale

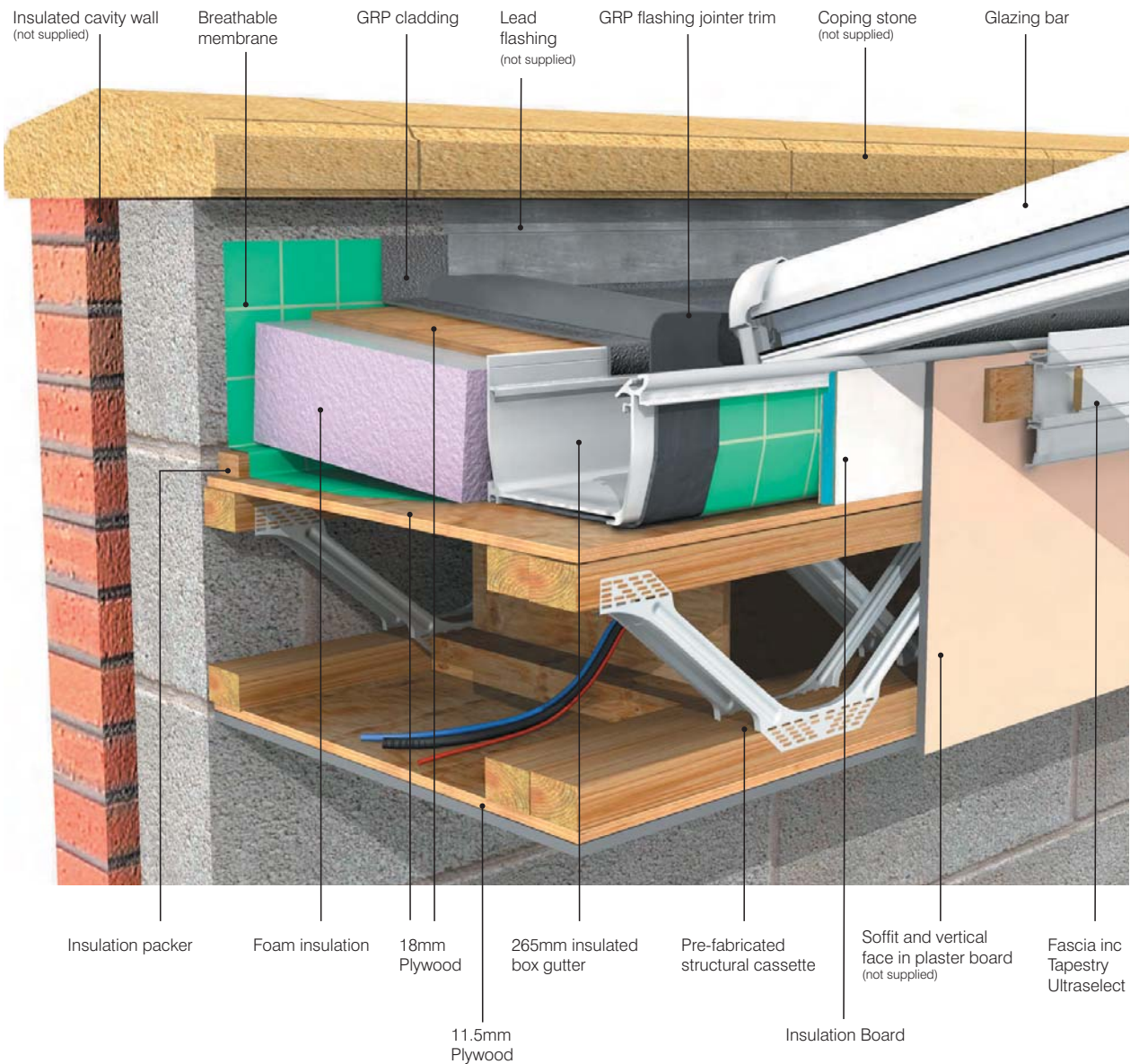

Orangery Installation



Complete the walls to 1 brick above the lintel on both leaves of masonry. (Lintel missing to ensure clarity of image.)



Place the lateral structural cassettes A & B on the inner leaf of the cavity wall. Ensure adequate lifting capacity - eg. Genie Lifts.



Locate the structural cassettes in position as shown

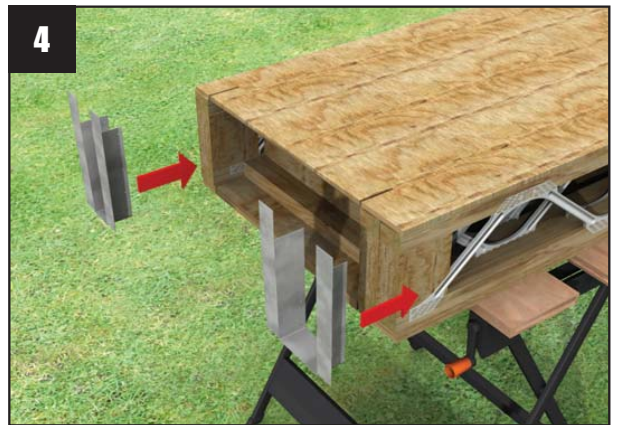

Fit the hanger brackets to structural cassettes C & D.

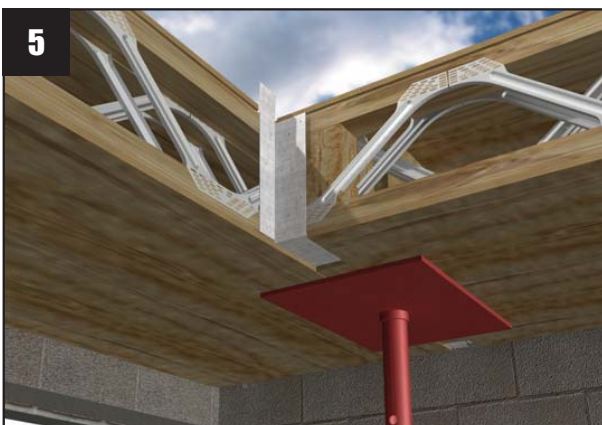

Offer up structural cassettes C & D as shown. Ensure the lower faces are supported using props as shown. The critical thing is to make sure the underside of both cassettes are level.



From the top, tap down the hanging bracket tab and secure in place using 65mm round head nails.

Orangery Installation

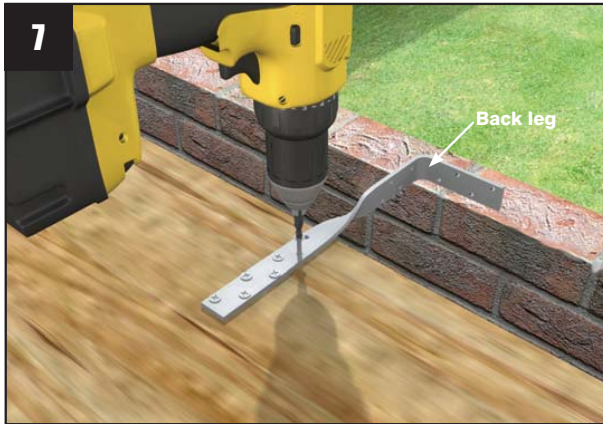

Next fasten the angled tie brackets to the cassettes ensuring that it lines up with the mortar joint - the back leg should fit flush to the inner leaf of masonry.

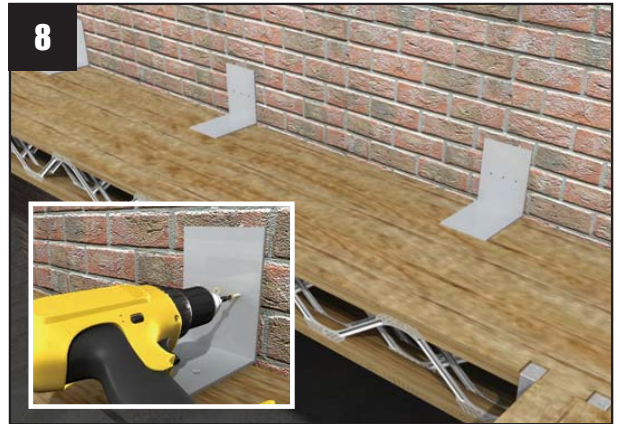

Fix the structural cassettes to the host wall with the 'L' shape brackets provided. Fix at approx 1000mm centres. **Note: The number of brackets supplied is dependant on the Orangery specification and varies from project to project.**



Slide the long fixing brackets down between the structural cassette and the inner leaf of masonry. Screw fix to the structural cassette. **Note: The number of brackets supplied is dependant on the Orangery specification and varies from project to project.**



Fix the long fixing brackets to the walls using the appropriate fixings for the substrate.



The cassettes have timber packers pre installed around the perimeter of the structural cassettes but **NOT** where the noggin positions are. This supports the slab insulation and creates a pitch.

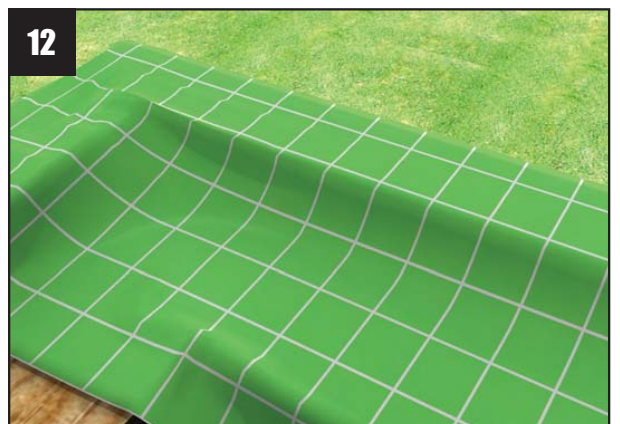

Lay the breathable membrane in position.

Orangery Installation

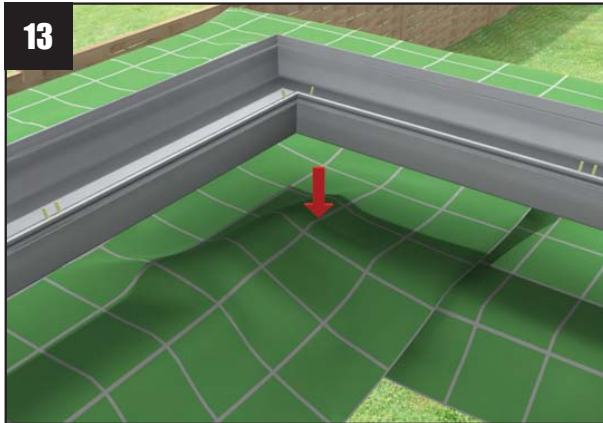

Lay the box gutter in position.

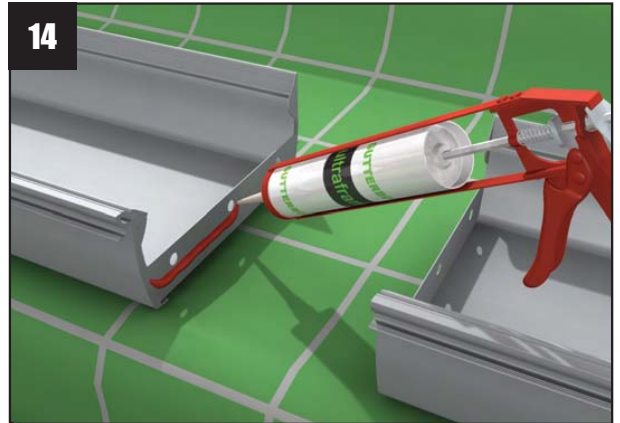

Run a bead of Gutterbond (supplied) around the joint as shown, prior to fixing the box gutter sections together. Please ensure that the supplied stainless steel nuts and bolts are used.



Dress the joint with lead.



Screw fix the box gutter down to the structural cassette using the brackets supplied.

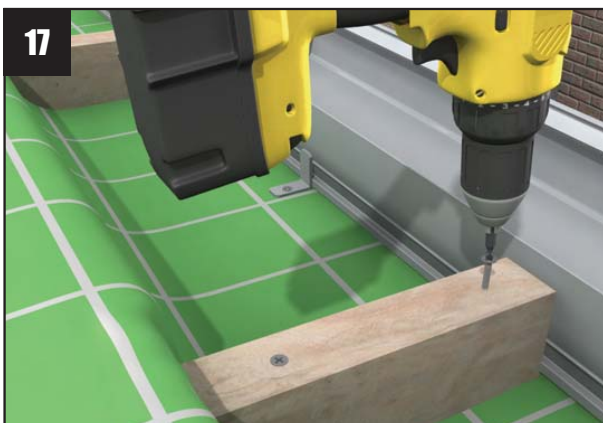

Screw fix the pre-cut timber noggins into position. Use the markings on the box gutter to determine the positions. The noggins sit flat onto the cassettes.

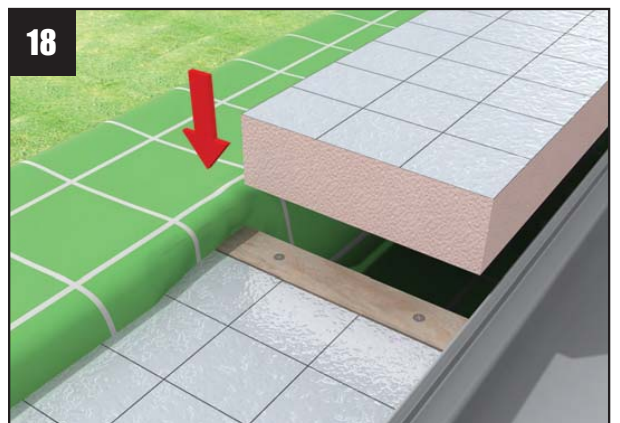

Lay in place the pre-cut insulation slabs.

Orangery Installation

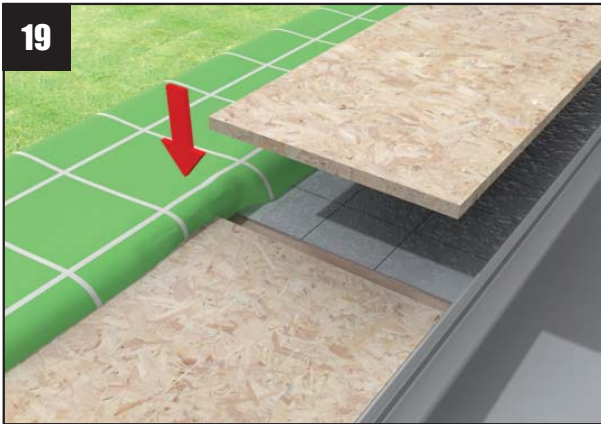

Fit the pre-cut 18mm plywood top panels and screw down to the noggins



Having raised the masonry to its finished levels, lay the pre-formed GRP panels into position.

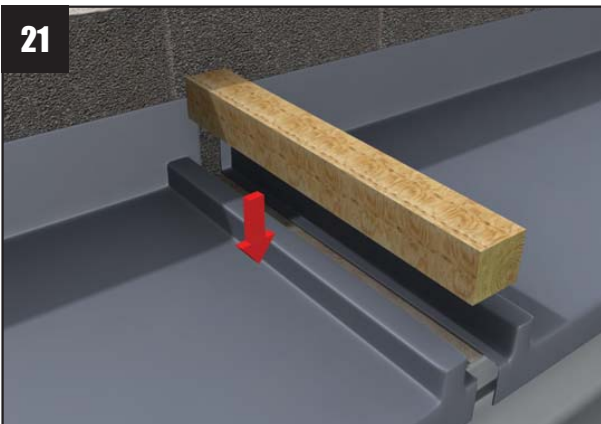

Fit the timber fillet between the the GRP panels.

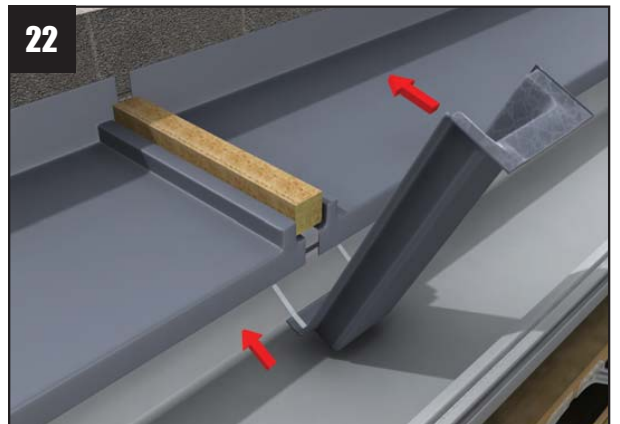

Fit the GRP joint cover.. First position the cover as shown and slide the two prongs under the front edge of the GRP panel. Roll back 90° into the finished position. Screw fix the back edge to the parapet wall.

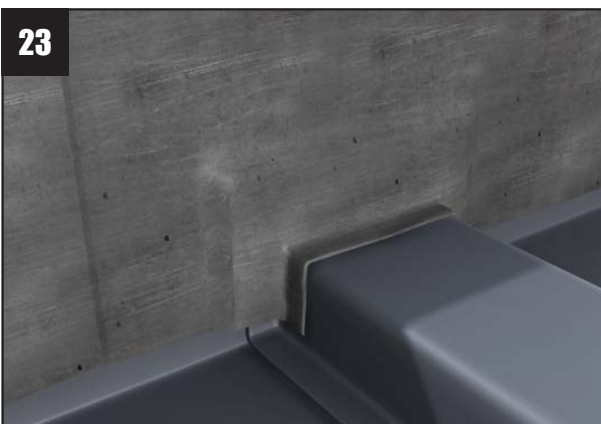

Using lead, flash over the GRP panels around the perimeter of the Orangery roof. Attach coping stone.

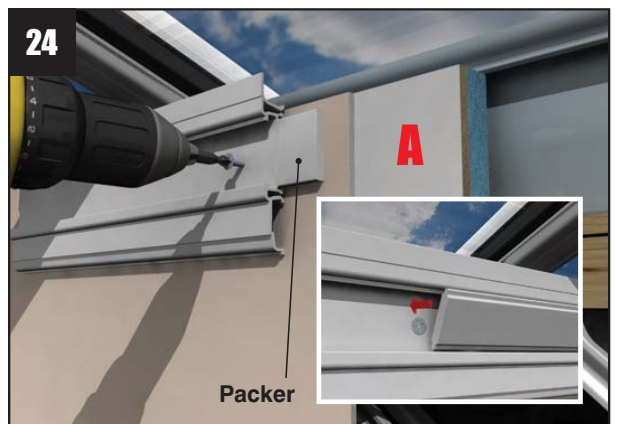

Bond the insulation panel to the box gutter (A), then having plaster-boarded the soffit and fascia, fit the internal fascia trim by screw fixing through the fascia as shown, ensuring a packer piece is used behind each fixing to ensure the trim isn't compressed. Then add the ultraslect trim.

Orangery Installation



25 Now all the masonry is completed, trim the back edge of the hopper to hide the outlet. The outlet is fitted with a capillary groove to prevent water tracking back.



26 Now it is time to fix the window frames into the masonry. Attach the 'Z' shaped brackets to the frames. Notch the frame rib extrusions first to ensure 'Z' bracket seats correctly.



27 The frames are now offered into position and the 'Z' brackets attached to the underside of the cassette - they should fit neatly into the pre-rebated pockets in the soffit of the cassette.

Cassette is fixed through the host wall

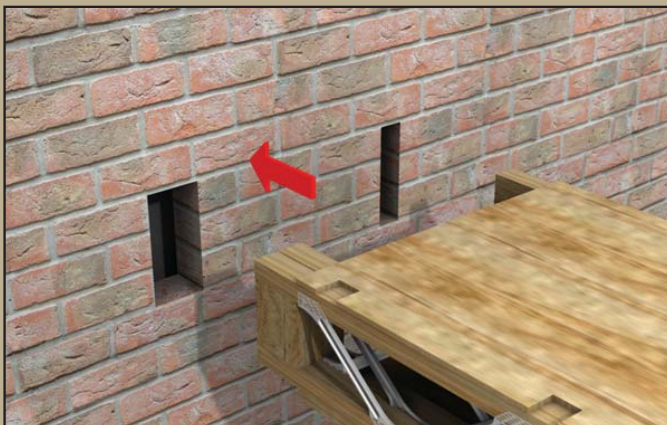

If the primary cassettes are at 90° to the host wall, a pocket in the host wall is needed. Pack with slate to level and then make good.

ultraframe

Ultraframe (UK) Ltd, Salthill Road, Clitheroe, Lancashire. BB7 1PE

Ultraframe is a trading name of
Ultraframe (UK) Ltd.

www.ultraframe.co.uk

It is Ultraframe's policy to continually seek to improve its products, processes and services, and we reserve the right to change specifications without prior notice. Ultraframe is a trading name of Ultraframe (UK) Limited

010001 IW 01000 02/11